

HCX-BW-SST

Column level indicators for hot water



ELESA Original design



INOX
Stainless Steel

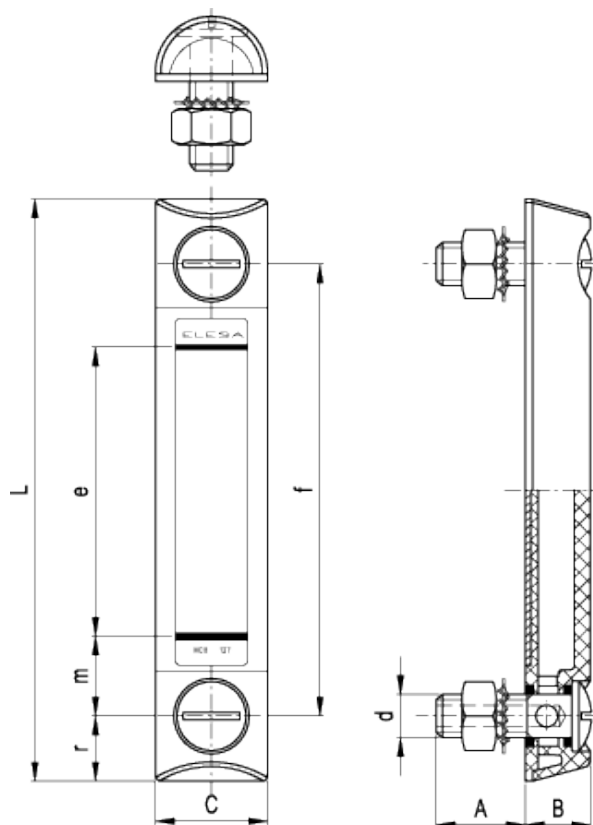

technical informations

Material

Transparent polyamide based (PA-T) technopolymer. Highly resistant to shocks, solvents, oils with additives, aliphatic and aromatic hydrocarbons, petrol, naphtha, phosphoric esters. Avoid contact with alcohol or detergents containing alcohol. The special technopolymer used for HCX.INOX-BW column level indicator allows to use it even in circuits working with very hot water and prevents milk effect on the transparent surface.

Screws, nuts and washers

AISI 303 stainless steel screws, AISI 304 stainless steel nuts and washers.

Packing rings

FKM (type VITON[®], registered trade mark of DuPont Dow Elastomers) O-Ring.

Contrast screen

White lacquered aluminium. The housing, in the appropriate external rear slot, guarantees the best protection from direct contact with fluid, avoiding yellowing effect due to the prolonged action of the fluid at high temperatures. It can be removed before installation to fit marks and words (for example MAX-MIN).

Assembly

- When nuts can be fitted from the inside of the reservoir, by means of the supplied set screws and nuts.
- When nuts cannot be fitted from the inside of the reservoir and the walls are thick enough, by means of the supplied set screws, without nuts, by tapping the two holes in the reservoir walls.

To ensure the best sealing of the O-rings it is recommended to apply the maximum torque on the nuts as reported in the table and a roughness of the gasket application surface $R_a = 3 \mu\text{m}$.

Maximum continuous working temperature

80°C with peaks of 90°C.

Features and performances

Assembled using ultrasound welding to guarantee a perfect seal. Entirely in transparent material: maximum fluid level visibility even from side positions. Visibility magnified by lens effect.

Technical data

In laboratory tests carried out with mineral oil for hydraulic systems type CB68 (according to ISO 3498) with gradually increasing pressure, at 23°C, the weld stood up as follows:

- HCX.76-INOX-BW 10 bar
- HCX.127-INOX-BW 10 bar
- HCX.254-INOX-BW 10 bar

In any case we suggest to verify the suitability of the product under the actual working conditions. If you need to use the indicator with other fluids and under different pressure and temperatures conditions, please contact ELESA Technical Department or carry out tests in order to guarantee a proper use.

Special executions on request

Indicators with two red ball-shaped floats.



Standard Elements		Main dimensions									Weight
Code	Description	f	d	A	B	C	L	e	m	r	g
11345	HCX.76-BW-SST-M10	76	M10	22	16	27	107	40	18	15.5	87
11355	HCX.127-BW-SST-M12	127	M12	23	18	31	161	80	23	17	138
11365	HCX.254-BW-SST-M12	254	M12	21	18	35	291	203	26	18.5	185

Drilling template

Holes without burrs and chamfer

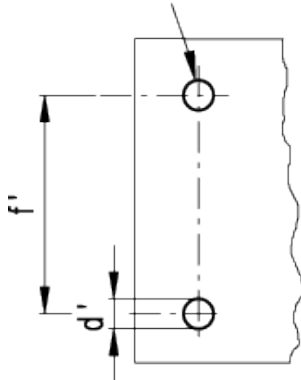

Drilling and installation data

Description	$d'_{-0.2}$	$f'_{\pm 0.2}$	Maximum tightening torque [Nm]
HCX.76	10.5	76	8
HCX.127	12.5	127	8
HCX.254	12.5	254	8



ELESA and GANTER models all rights reserved in accordance with the law. Always mention the source when reproducing our drawings.

STANDARD MACHINE ELEMENTS WORLDWIDE